

When you are folding the right half of the rear seat, use the latch plate to release the center seat belt from the detachable anchor (see page 108 ). Allow the seat belt to retract into the holder on the ceiling and store the buckles in it.

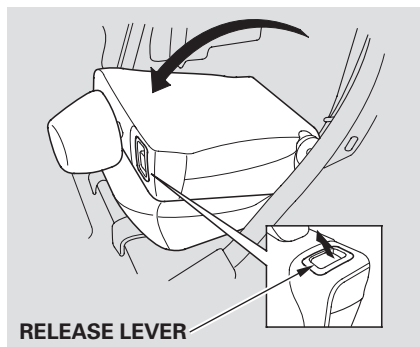

2. Lower the head restraint to its lowest position.
3. Pull up on the release lever on the outside of the seat-back.
4. Fold the seat-back forward.

Do not put any heavy items on the seat-back when it is folded.

Reverse this procedure to return the seat-back to the upright position. Tug on the seat-back to make sure it is latched. Position the seat belt in front of the seat-back. Make sure the seat is locked securely before driving.

*CONTINUED*